

6536-03-04/74  
 CTH J - STH 49  
 CTH AA TO CTH V  
 CTH A  
 GREEN LAKE COUNTY

GREEN LAKE COUNTY

WAUSHARA CO.

R-12-E

89° 00'

Town of Marion

Town of Warren

Town of Aurora

T-17-N

MARQUETTE CO.

Town of Neeshk

Town of Nepestatun

T-17-N

WINNEBAGO CO.

T-16-N

Town of Mecan

Town of Ripon

T-16-N

FOND DU LAC CO.

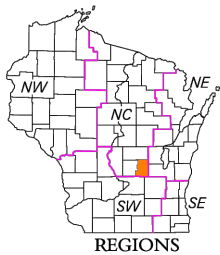

REGIONS

PROJECT LOCATION

T-15-N

45° 45'

MARQUETTE CO.

Town of Momeillo

Town of Buffalo

T-14-N

Town of Scott

R-11-E

COLUMBIA CO.

Town of I

COLUMBIA CO.

T-15-N

43° 45'

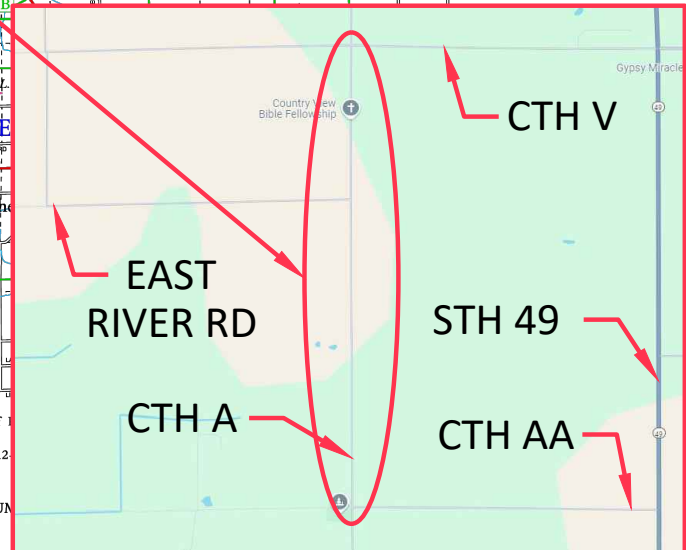

MILES OF HIGHWAY  
 as of Dec. 31, 2019

STATE	70
COUNTY	228
LOCAL ROADS	405
OTHER ROADS	0
TOTAL FOR COUNTY	703

Land Area (2010 Census) .....349 sq mi  
 Population (2010 Census) .....19051  
 County Seat .....Green Lake

For boundaries of public hunting and fishing grounds please contact the Department of Natural Resources

LEGEND

- Freeway
- Multilane Divided
- U.S. or State Hwy
- County Trunk Hwy
- Town Road
- Firelane
- Railroad
- State Trail
- Interchange
- Highway Separation
- Interstate Highway No.
- U.S. Highway No.
- State Highway No.
- County Highway Letter
- State Boundary
- County Boundary
- Civil Town Boundary
- Section Line
- Dam
- Hospital
- Airport
- County Seat
- Unincorporated Village
- Fish Hatchery
- Game Farm
- Public Hunt. or Fish. Grds.
- Public Camp & Picnic Grds.
- Ranger Station
- State Park
- County Park
- Without Facilities
- Rest Area
- Wayside
- Modern Facilities
- Russic Facilities

CIVIL TOWNS

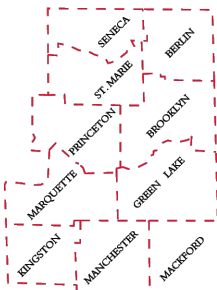

SECTION NUMBERING OF A TOWNSHIP

6	5	4	3	2	1
7	8	9	10	11	12
13	14	15	16	17	18
19	20	21	22	23	24
25	26	27	28	29	30
31	32	33	34	35	36

GREEN LAKE CO.

DEPARTMENT OF TRANSPORTATION  
 Madison, Wisconsin

SCALE 0 1 2 MILES

Corrected for  
 JAN. 2021

Base compiled from U.S.G.S. Quadrangles  
 1:100,000 Series