

# Public Involvement Handout

**County A  
County AW to County I  
Green Lake County**

Project ID: 6536-03-73



**Public Comment Period:  
January 6, 2023 to February 17, 2023**

## Purpose

Our objective is to obtain your input on the proposed improvement along County A from County AW to County I in the Town of Mackford, Green Lake County.

## Project information

WisDOT and Green Lake County are proposing to improve 4.04 Miles of County A. The existing pavement is aged and deteriorated with extensive alligator cracking, edge cracking, patching, and transverse cracking, resulting in a rough riding surface.

The purpose of the proposed action is to preserve County A and maximize the life of the roadway.

### CTH A location

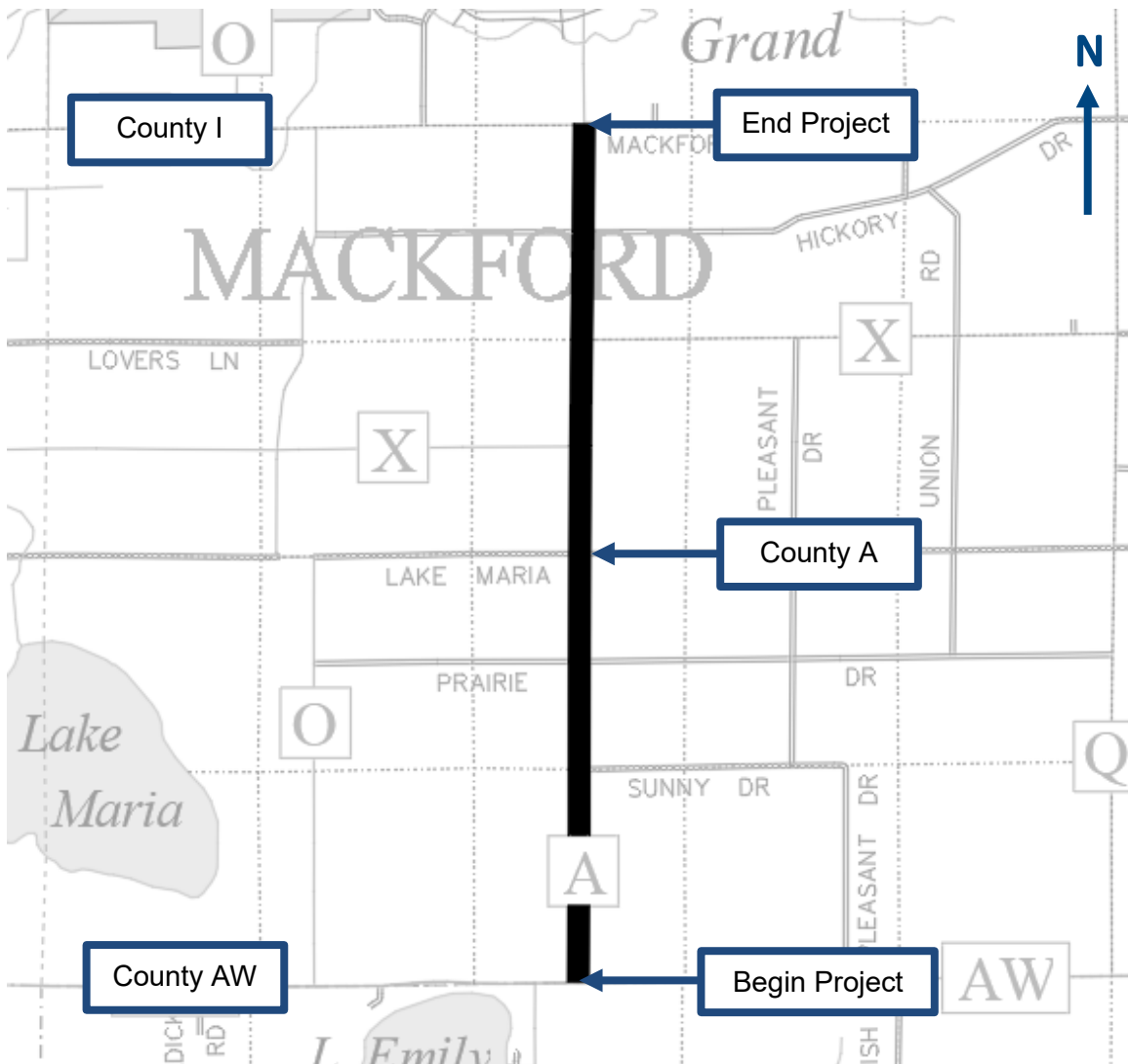

## Proposed improvements

The proposed project includes cold in-place recycling (CIR) the top 4-inches of existing asphaltic surface and relaying the CIR material on top of the remaining 2-inches of existing asphaltic surface. The relayed material will then be overlaid with 3-inches of new asphaltic material. The proposed shoulders will match the existing 4-foot shoulders (2-foot paved, 2-foot unpaved).

CIR is a cost-effective resurfacing technique that reuses existing materials, corrects asphalt defects, extends roadway life, and improves transit performance. The existing roadway is partially milled. Then, the milled materials are crushed and mixed with a stabilizing agent, usually foamed asphalt. Next, the recycled mixture is paved immediately back on top of the remaining roadway using a traditional paving machine and compacted using rollers. Lastly, after curing is complete, a new layer of asphalt is laid on top of the CIR material as a wearing course layer.

## Proposed traffic impacts

Construction is anticipated to begin in the spring/summer of 2025.

During construction, County A will be closed to through traffic. The intersections of County A and Sunny Drive, County A and Prairie Drive, County A and Lake Maria Road, County A and County X, County A and Hickory Drive will also be closed to through traffic.

Brief interruptions in access may occur temporarily at driveways and field entrances when construction operations occur immediately in front of the entrance. The construction project manager will be required to contact landowners in advance before closing driveways.

Construction is currently scheduled for completion in the fall of 2025.

## Real estate

No additional right of way is anticipated for this project

## Project update/next steps

- |                                |                    |
|--------------------------------|--------------------|
| • Preliminary Design and Plans | January 2023       |
| • Environmental Document       | May 2023           |
| • Design Study Report          | January 2024       |
| • Final (90%) Plans            | April 2024         |
| • PS&E                         | August 2024        |
| • Let Date                     | November 2024      |
| • Construction                 | Spring/Summer 2025 |

## Public input/comments

Your comments assist us in developing a project that will serve the needs of the traveling public as well as the needs of the local community. Your input is welcome and appreciated throughout the design process.

There are several ways to submit your feedback by **February 17, 2023**:

1. Fill out the comment form listed on the Green Lake County Highway Department website under the “Current Projects” tab and mail it to Westbrook Associated Engineers, Inc. The exact link to the presentation is:  
[https://www.greenlakecountywi.gov/wp-content/uploads/2018/05/65360373\\_CTH-A-CTH-AW-to-CTH-I\\_PIM-Presentation.pdf](https://www.greenlakecountywi.gov/wp-content/uploads/2018/05/65360373_CTH-A-CTH-AW-to-CTH-I_PIM-Presentation.pdf)
2. Email comments or questions to the contact(s) listed below.

For more information, please contact:

Derek Mashuda  
Green Lake County Highway Commissioner  
570 South St  
Green Lake, WI 54941  
(920) 294-4062  
[dmashuda@greenlakecountywi.gov](mailto:dmashuda@greenlakecountywi.gov)

Erik Meyer, P.E.  
Westbrook Associated Engineers, Inc.  
P.O. Box 429  
Spring Green, WI 53588  
(608) 588-7866  
[emeyer@westbrookeng.com](mailto:emeyer@westbrookeng.com)